

THE WATERMARK AT SAN JOSE

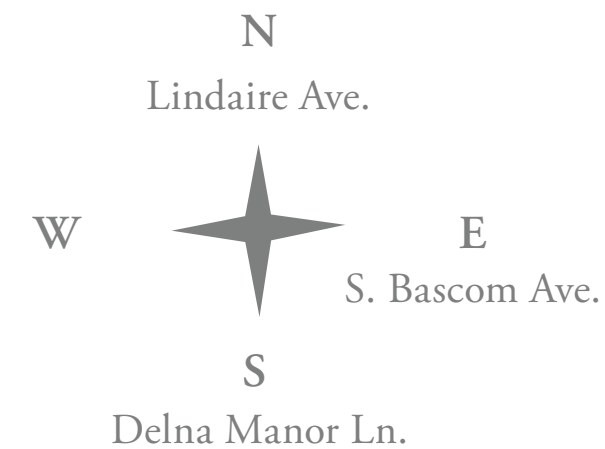

- Restaurants
- Engagement
- Wellness

FIRST FLOOR

Leasing Gallery: 969 South Bascom Avenue, San Jose, CA 95128 | Community: 1015 South Bascom Avenue, San Jose, CA 95128 | 669-321-5500 | WatermarkSanJose.com

Site plans are not to scale and are shown for comparative purposes only. Actual apartment floor plans may have minor variations.

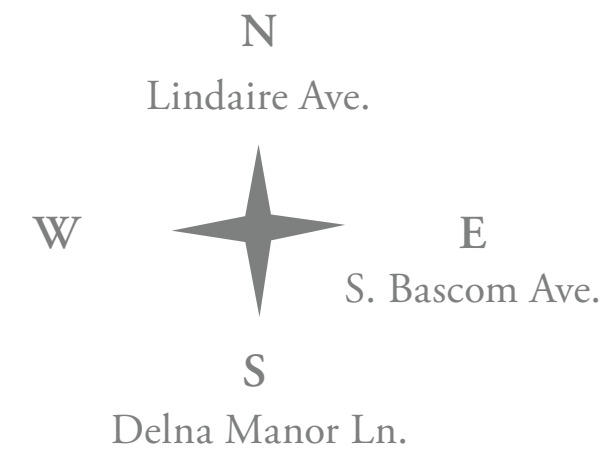

- Restaurants
- Engagement
- Wellness
- Palm Haven
- Naglee Park
- Almaden Valley
- Santa Clara

SECOND FLOOR

Leasing Gallery: 969 South Bascom Avenue, San Jose, CA 95128 | Community: 1015 South Bascom Avenue, San Jose, CA 95128 | 669-321-5500 | WatermarkSanJose.com

Site plans are not to scale and are shown for comparative purposes only. Actual apartment floor plans may have minor variations.

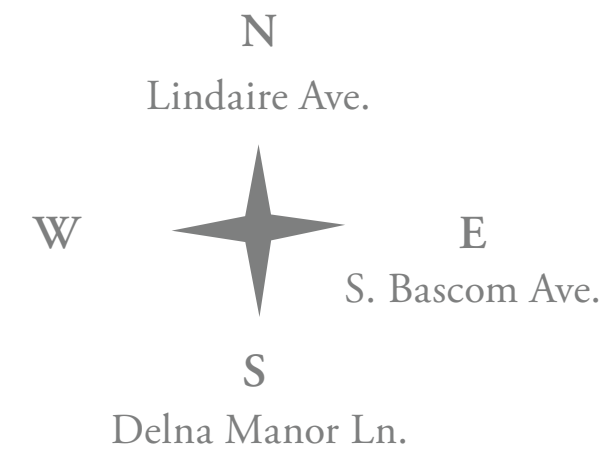

- Palm Haven
- Japantown
- Rose Garden
- Willow Glen
- Blossom Valley
- Evergreen

THIRD FLOOR

Leasing Gallery: 969 South Bascom Avenue, San Jose, CA 95128 | Community: 1015 South Bascom Avenue, San Jose, CA 95128 | 669-321-5500 | WatermarkSanJose.com

Site plans are not to scale and are shown for comparative purposes only. Actual apartment floor plans may have minor variations.

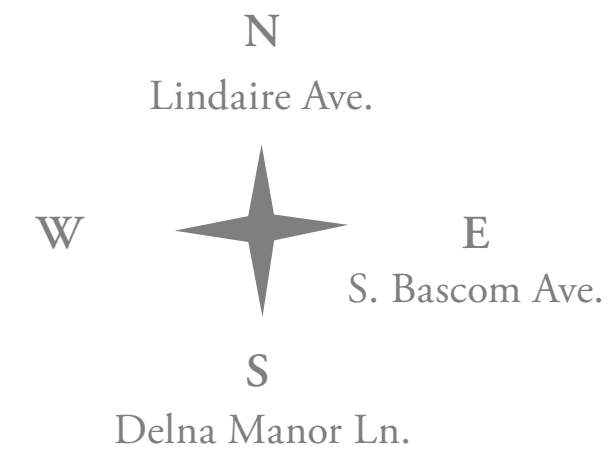
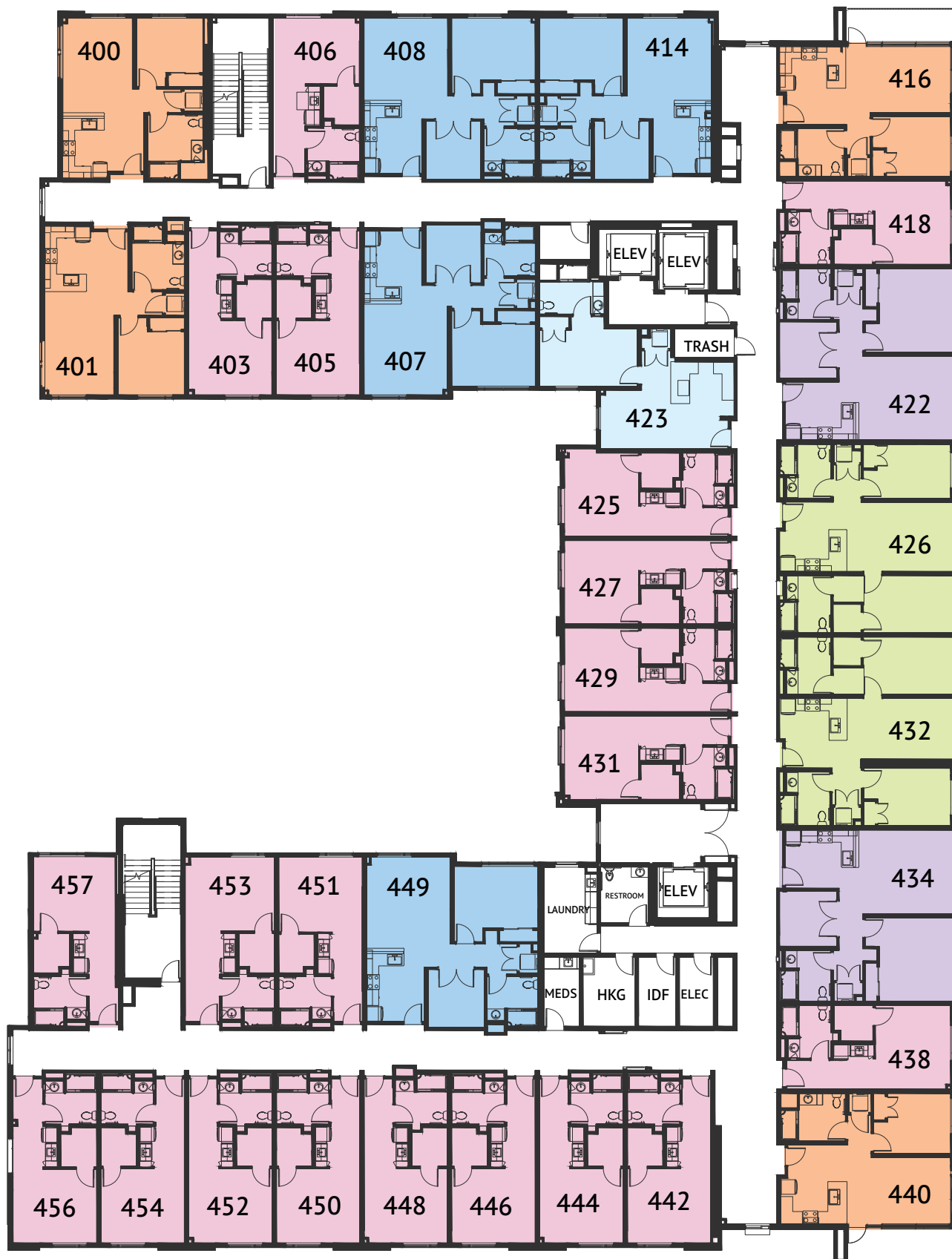

- Palm Haven
- Japantown
- Rose Garden
- Willow Glen
- Blossom Valley
- Evergreen

FOURTH FLOOR

Leasing Gallery: 969 South Bascom Avenue, San Jose, CA 95128 | Community: 1015 South Bascom Avenue, San Jose, CA 95128 | 669-321-5500 | WatermarkSanJose.com

Site plans are not to scale and are shown for comparative purposes only. Actual apartment floor plans may have minor variations.

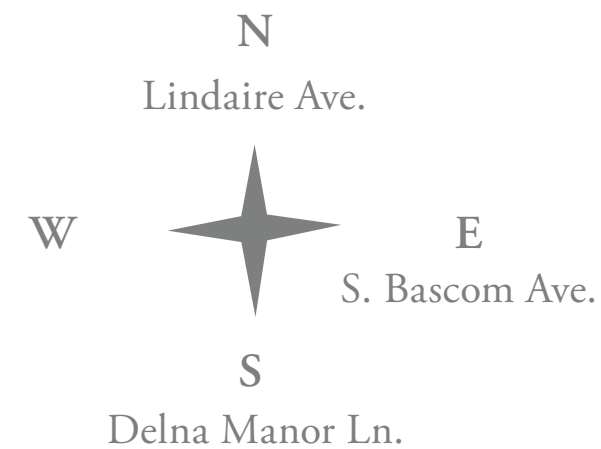
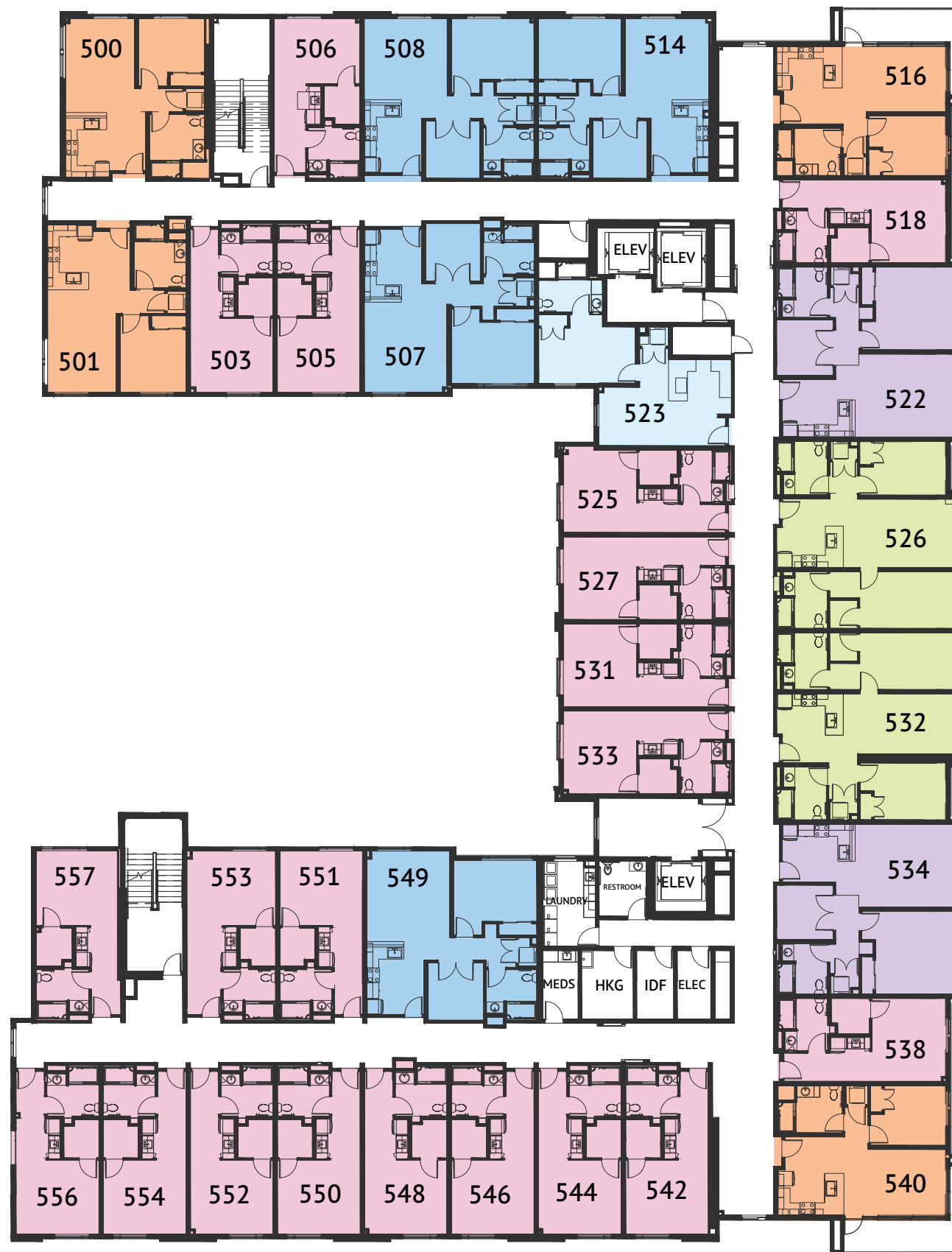

- Palm Haven
- Japantown
- Rose Garden
- Willow Glen
- Blossom Valley
- Evergreen

FIFTH FLOOR

Leasing Gallery: 969 South Bascom Avenue, San Jose, CA 95128 | Community: 1015 South Bascom Avenue, San Jose, CA 95128 | 669-321-5500 | WatermarkSanJose.com

Site plans are not to scale and are shown for comparative purposes only. Actual apartment floor plans may have minor variations.

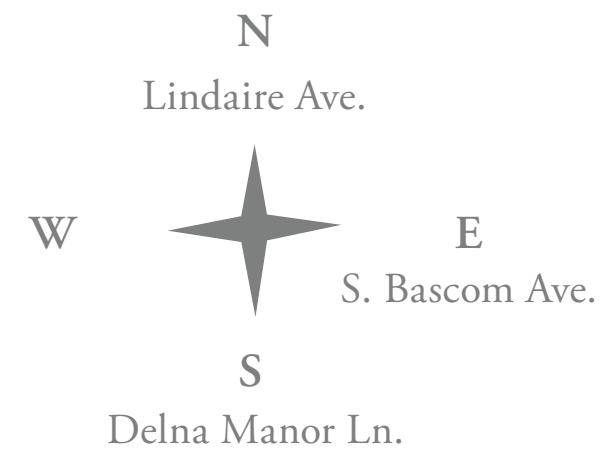

- The Alameda
- Evergreen
- Alviso
- Alum Rock
- Mayfair
- Palm Haven
- Japantown
- Rose Garden
- Willow Glen
- Blossom Valley

SIXTH FLOOR

Leasing Gallery: 969 South Bascom Avenue, San Jose, CA 95128 | Community: 1015 South Bascom Avenue, San Jose, CA 95128 | 669-321-5500 | WatermarkSanJose.com

Site plans are not to scale and are shown for comparative purposes only. Actual apartment floor plans may have minor variations.